



SMD Schottky Bridge Rectifiers



1 Amp
CBRHDSH1-40L

2 Amp
CBRHDSH2-40



features

- $V_{RRM} = 40V$
- $I_O = 1.0 \text{ Amp}$ (CBRHDSH1-40L)
2.0 Amp (CBRHDSH2-40)
- $V_F = 0.39V \text{ TYP. @ } 1.0A$ (CBRHDSH1-40L)
0.45V TYP. @ 2.0A (CBRHDSH2-40)

description

The New Central Semiconductor CBRHDSH1-40L and CBRHDSH2-40 are full wave glass passivated bridge rectifiers manufactured in a durable HD DIP surface mount package. Designed for applications requiring an energy efficient alternative to standard general purpose bridge rectification.

Sample Devices
available
upon request.

selection guide



			Other Surface Mount Bridge Rectifiers Manufactured by Central™					
I_O (AMPS)	2.0	1.0	1.0			0.5	0.14	
@ T_A (°C)	25	25	50	40	40	40	25	25
I_{FSM} (AMPS)	30	20	50	50	50	30	-	-
CASE								
V_{RRM} (VOLTS)	SCHOTTKY	LOW V_F SCHOTTKY	GENERAL PURPOSE	FAST RECOVERY	ULTRA FAST RECOVERY	GENERAL PURPOSE	FAST RECOVERY	FAST RECOVERY
40	CBRHDSH2-40	CBRHDSH1-40L	-	-	-	-	-	-
60	CBRHDSH2-60†	CBRHDSH1-60L†	-	-	-	-	CMFBR-6F	CMKBR-6F
100	CBRHDSH2-100†	CBRHDSH1-100L†	-	-	CBR1U-D010S	-	-	-
200	-	-	CBR1-D020S	CBR1F-D020S	CBR1U-D020S	CBRHD-02	-	-
400	-	-	CBR1-D040S	CBR1F-D040S	-	CBRHD-04	-	-
600	-	-	CBR1-D060S	CBR1F-D060S	-	CBRHD-06	-	-
1000	-	-	CBR1-D100S	CBR1F-D100S	-	CBRHD-10*	-	-
$V_F \text{ max @ } I_F$	0.50V @ 2.0A	0.44V @ 1.0A	1.1V @ 1.0A	1.3V @ 1.0A	1.05V @ 1.0A	1.0V @ 400mA	1.0V @ 20mA	1.0V @ 20mA
$I_R \text{ max @ } V_{RRM}$	50µA @ 40V	50µA @ 40V	10µA	5.0µA	5.0µA	5.0µA	10nA @ 50V	10nA @ 50V
t_{rr} (60V)	-	-	-	-	-	-	1.0µs (typ.)	1.0µs (typ.)
t_{rr} (100-400V)	-	-	-	200ns	50ns	-	-	-
t_{rr} (600V)	-	-	-	300ns	-	-	-	-
t_{rr} (1000V)	-	-	-	500ns	-	-	-	-

* Available on special order, please consult factory

† Under Development

SMD Schottky Bridge Rectifiers

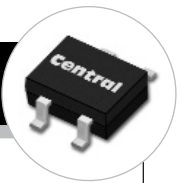

Mechanical Specifications - HD DIP

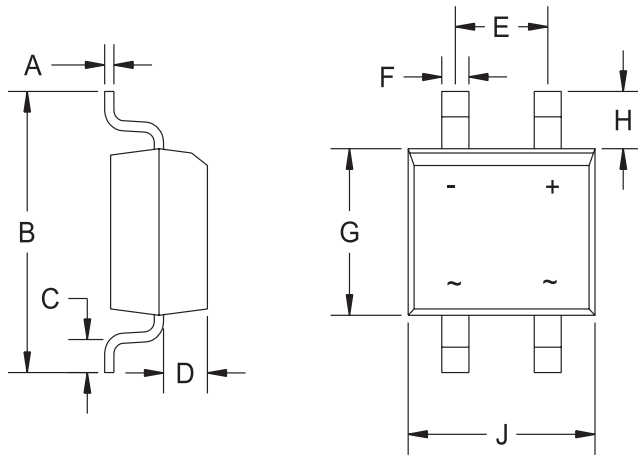

SYMBOL	INCHES		MILLIMETERS	
	MIN	MAX	MIN	MAX
A	0.006	0.014	0.15	0.35
B	-	0.276	-	7.00
C	0.028	0.043	0.70	1.10
D	0.035	0.051	0.90	1.30
E	0.091	0.106	2.30	2.70
F	0.020	0.031	0.50	0.80
G	0.142	0.157	3.60	4.00
H	0.051	0.067	1.30	1.70
J	0.177	0.193	4.50	4.90
K	0.091	0.106	2.30	2.70
L	-	0.008	-	0.20
M	-	0.118	-	3.00

HD DIP (REV: R1)

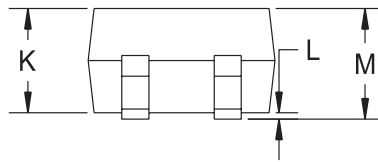

MARKING CODE:

CBRHDSH1-40L CSH1

CBRHDSH2-40 CSH2

R1

Tape Dimensions and Orientation (Dimensions in mm)

Tape Width: 8mm

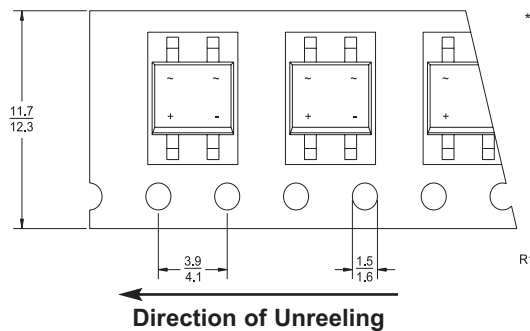

* Devices are taped in accordance with Electronic Industries Association Standard EIA-481-1-A

R1

Mounting Pad Geometry (Dimensions in mm)

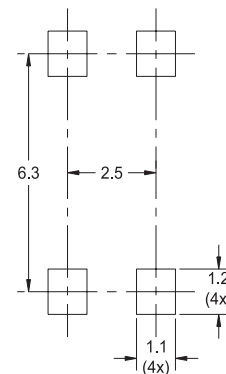

R1

CentralTM
Semiconductor Corp.

Innovations in Discrete Semiconductors

For further information contact:
Sales at Central Semiconductor Corp.
(631) 435-1110 or visit our website at:
www.centalsemi.com

145 Adams Avenue • Hauppauge • New York • 11788 • USA • Tel:(631) 435-1110 • Fax:(631) 435-1824

PA CBRHDSH Series